

DYKEMAN
INSPIRING EVERYDAY SPACES

425.359.3134 | Fax: 425.359.5202 | www.dykeman.net
1116 West Marine View Drive | Everett, WA 98201-5624
ARCHITECTURE | INTERIOR DESIGN | PLANNING

CONSULTANT:

REGISTRATION STAMPS:

PROJECT IDENTIFICATION:

SNOHOMISH STATION FOR WAKEFIELD DEVELOPMENT AT 2711 BICKFORD AVE. N. SNOHOMISH, WA

This drawing is:
1. Copyright 2005 DYKEMAN Architects P.C.
2. The Architect's exclusive or Professional Service.
For use on this project only. Other Architectural services performed for any other use or reproduction.

ISSUED:

DATE	DESCRIPTION
	OWNER APPROVAL
	PERMIT APPLICATION
	BIDDING
	CONSTRUCTION

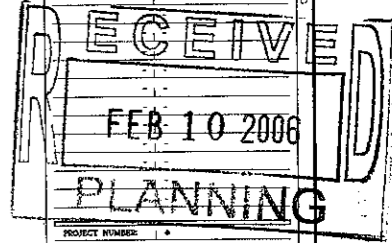

PROJECT NUMBER: *

APPROVED BY: _____

PROJECT DESCRIPTION: ACO

PROJECT ARCHITECT: _____

CHECKED BY: _____

JOB CAPTAIN: _____

DRAWN BY: _____

DATE: _____

DRAWING TITLE:

PRELIMINARY SITE PLAN

REVISIONS:

SD-1

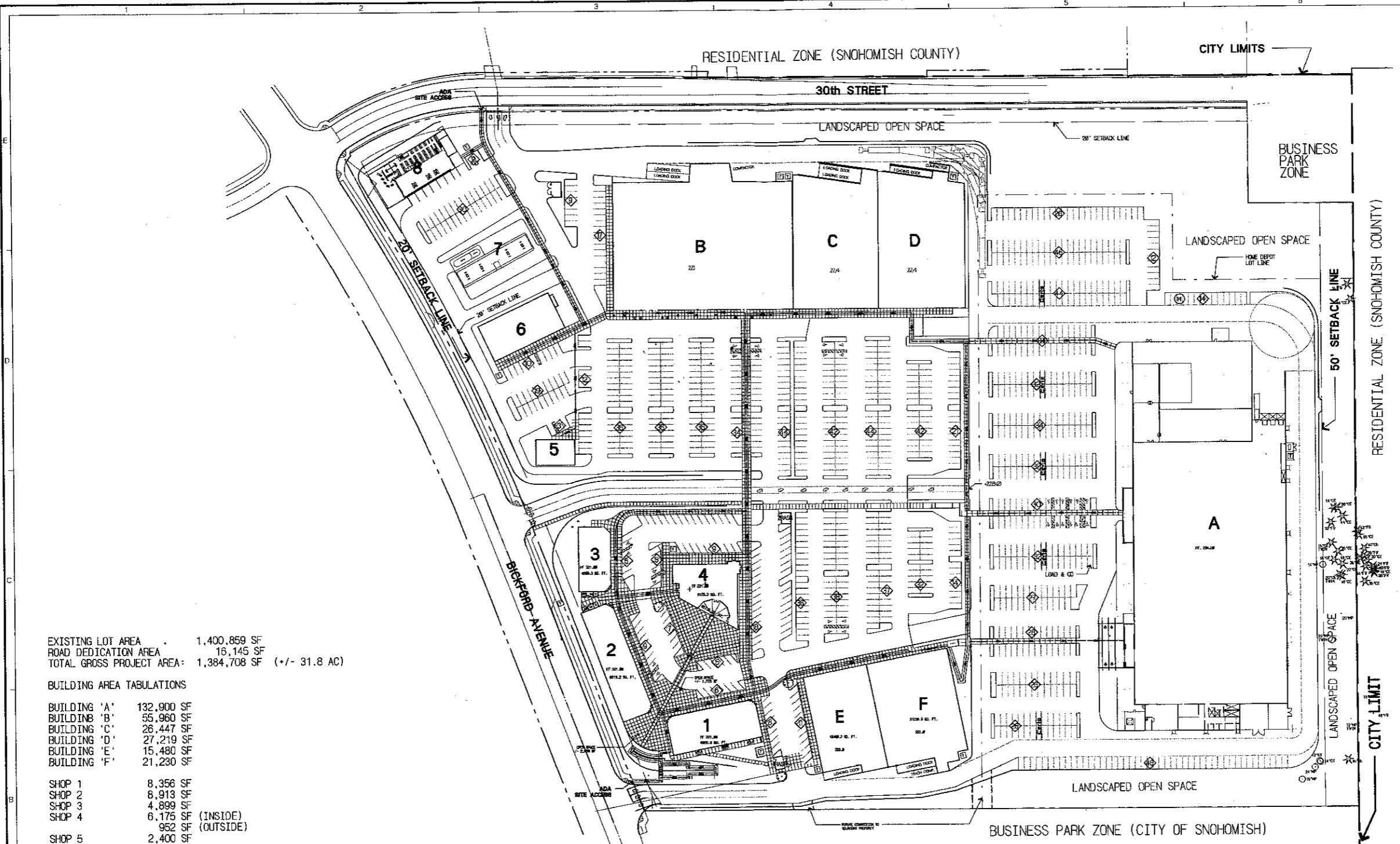

EXISTING LOT AREA 1,400,859 SF
ROAD DEDICATION AREA 16,145 SF
TOTAL GROSS PROJECT AREA: 1,384,708 SF (+/- 31.8 AC)

BUILDING AREA TABULATIONS

BUILDING 'A'	132,900 SF
BUILDING 'B'	55,960 SF
BUILDING 'C'	26,447 SF
BUILDING 'D'	27,219 SF
BUILDING 'E'	15,480 SF
BUILDING 'F'	21,230 SF

SHOP 1	8,356 SF
SHOP 2	8,913 SF
SHOP 3	4,899 SF
SHOP 4	6,175 SF (INSIDE)
	952 SF (OUTSIDE)
SHOP 5	2,400 SF
SHOP 6	7,200 SF
SHOP 7	96 SF
SHOP 8	7,853 SF

TOTAL 326,080 SF

PARKING AREA TABULATIONS

PARKING REQUIRED: 1 STALL / 300 SF
326,080 SF / 300 = 1087 STALLS
HC REQUIRED: 20 + 1/100 OVER 1,000 = 21
(WAC 51-20-3156)

PARKING PROVIDED:

1,104 STD STALLS	9'-0" WIDE
12 STD STALLS	10'-0" WIDE
25 H.C. STALLS	12'-0" WIDE
8 VAN ACC STALLS	16'-0" WIDE

TOTAL STALLS PROVIDED: 1,149 > 1,076 OK
HC STALLS PROVIDED: 33 > 21 OK

SITE PLAN

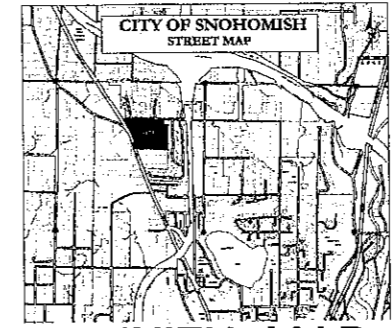

VICINITY MAP

PLOT DATE - 01-24-06

A. GARY O'LEARY, AIA
DYKEMAN ARCHITECTS
1716 WEST MARINE VIEW DRIVE, SUITE 200
EVERETT, WA 98201
(425) 259-3161 garyo@dykeman.net
OCTOBER 20, 2005
SW ¼, NE ¼, SEC 1, T 28 N., R 5 E., W.M.